

Via privata CADORE

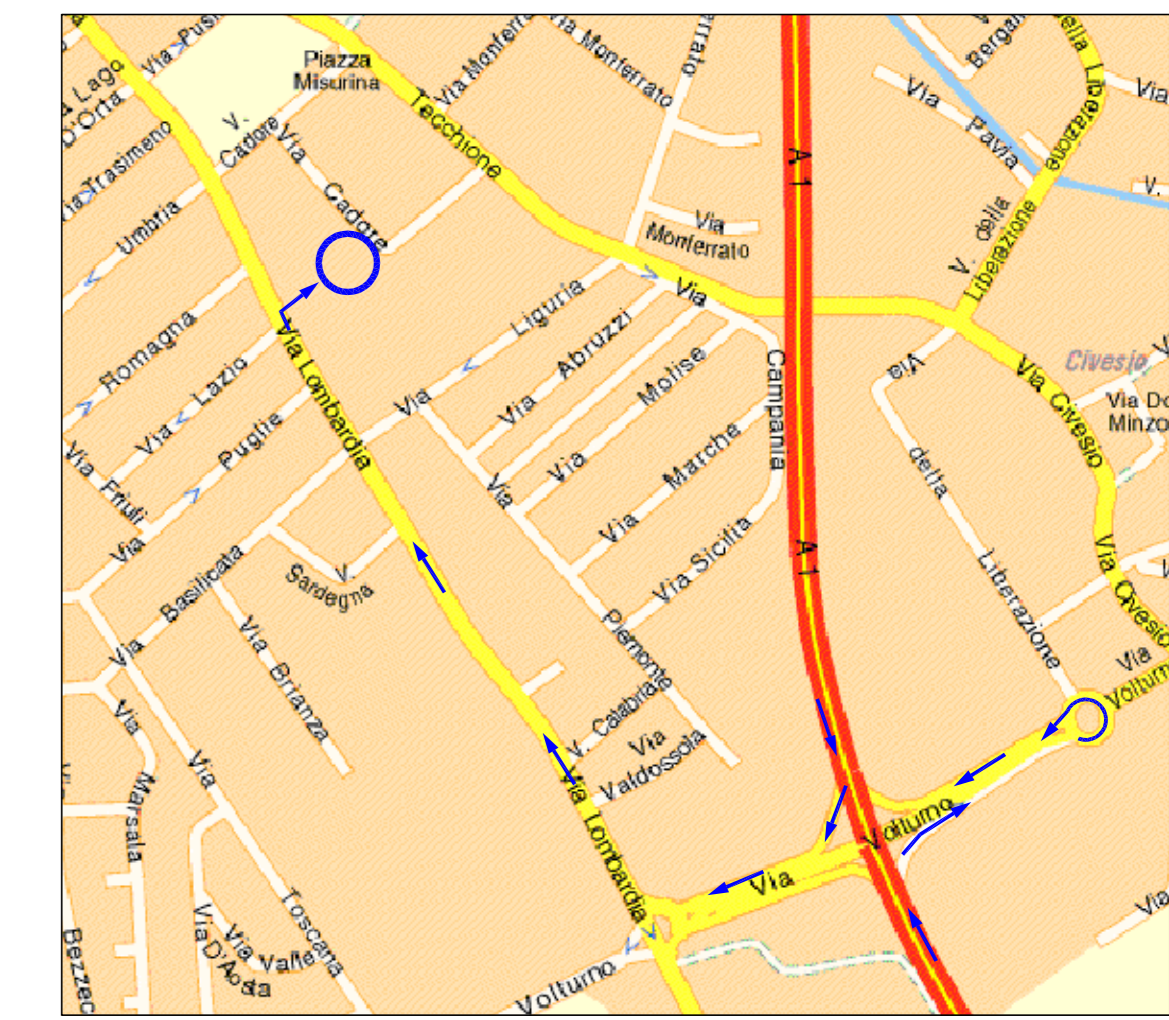

VISTA 1

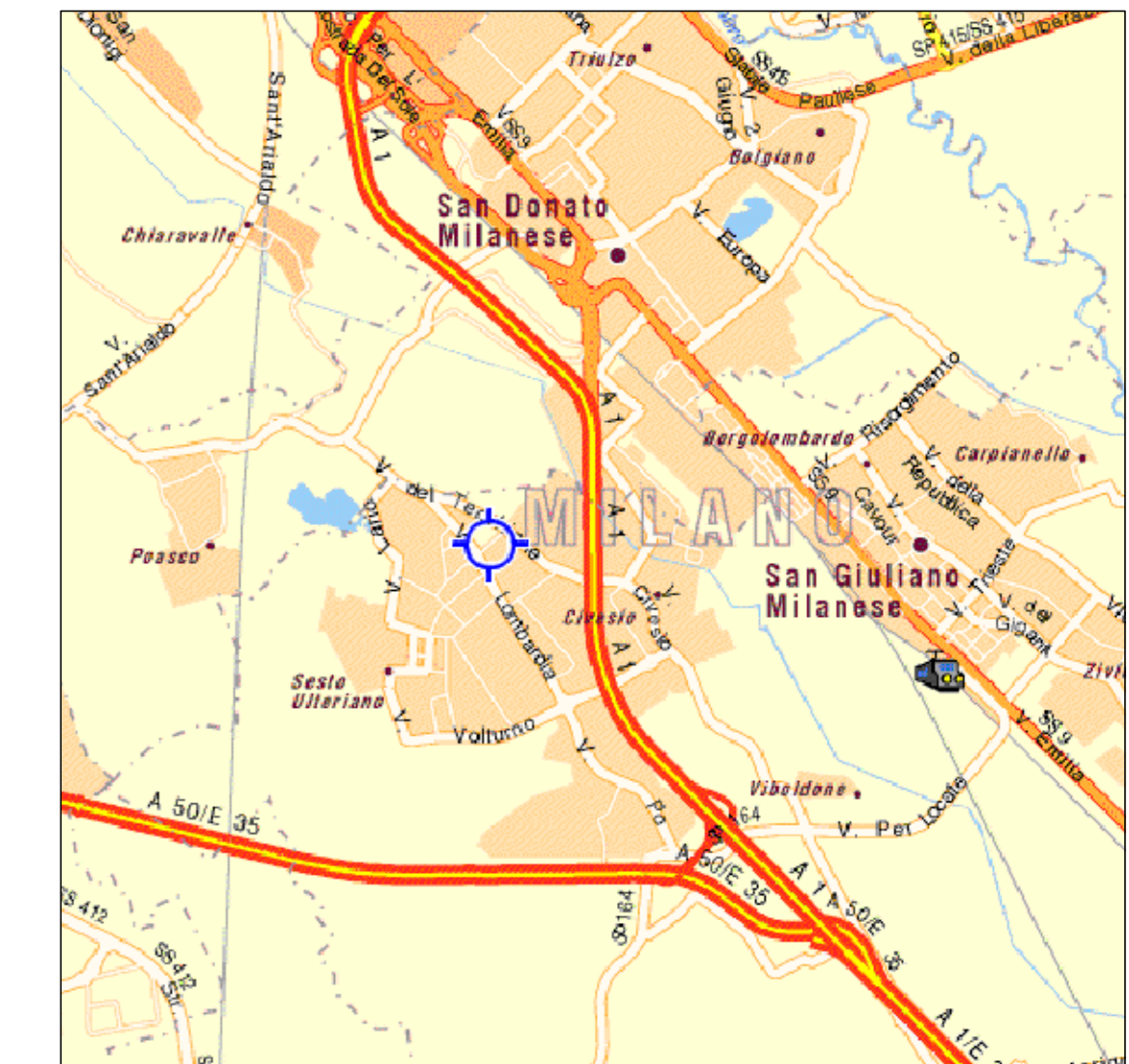
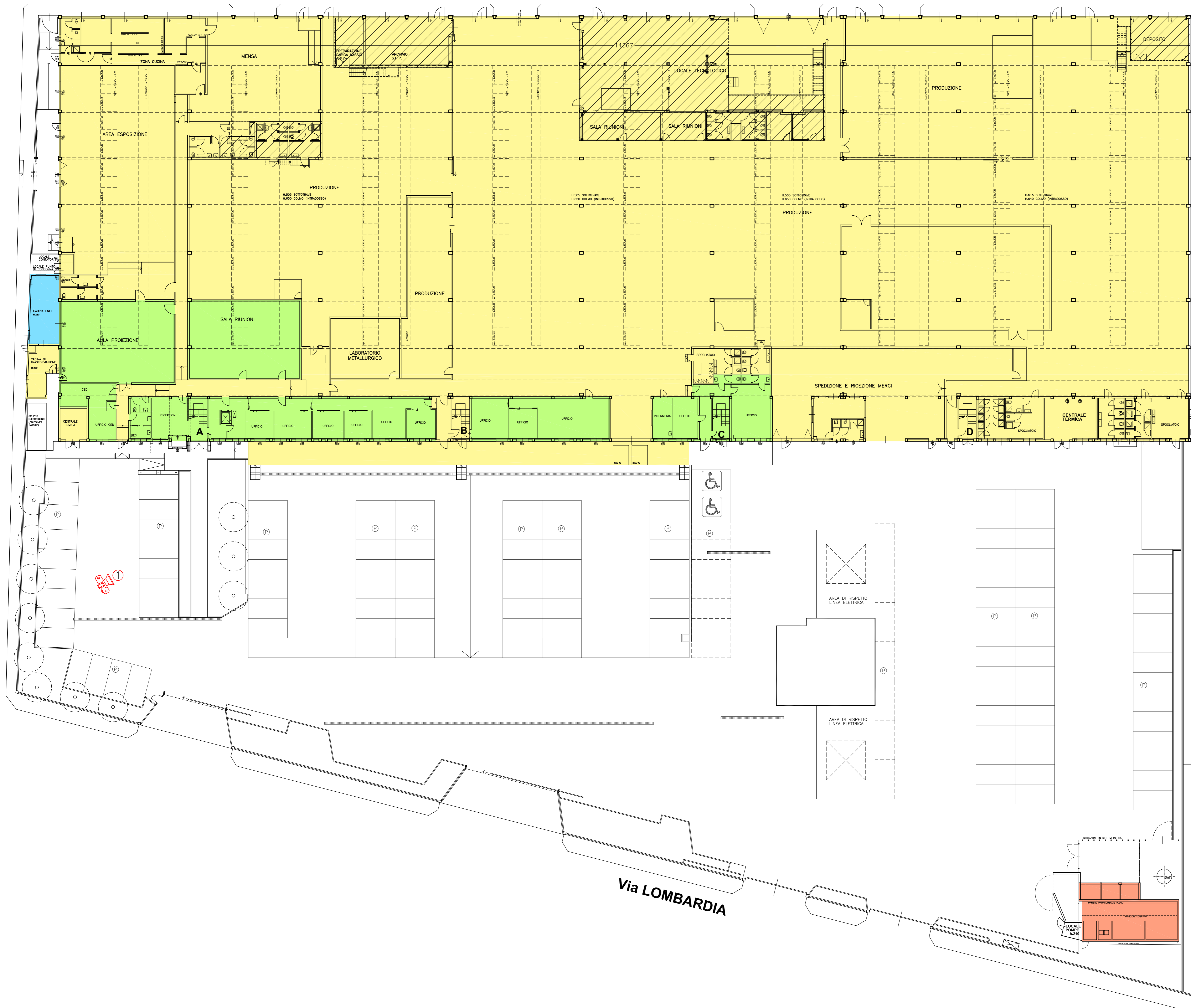

VISTA 2

LEGENDA

VISTA FOTOGRAFICA

LEGENDA SUPERFICI:

	S.L.P. UFFICI PIANO 1':	mq. 870,00
	S.L.P. UFFICI E SERVIZI P.T.:	mq. 766,00
	S.L.P. MAGAZZINO E SERVIZI:	mq. 7.186,00
	S.L.P. TOTALE:	mq. 8.822,00
	SOPPALCHI TECNICI	mq. 570,00
	CABINA ENEL	mq. 34,00
	DEPOSITI ESTERNI	mq. 82,00
	S.L.P. AREE SCOPERTE:	mq. 7.500,00 (circa)