

PIANO PRIMO

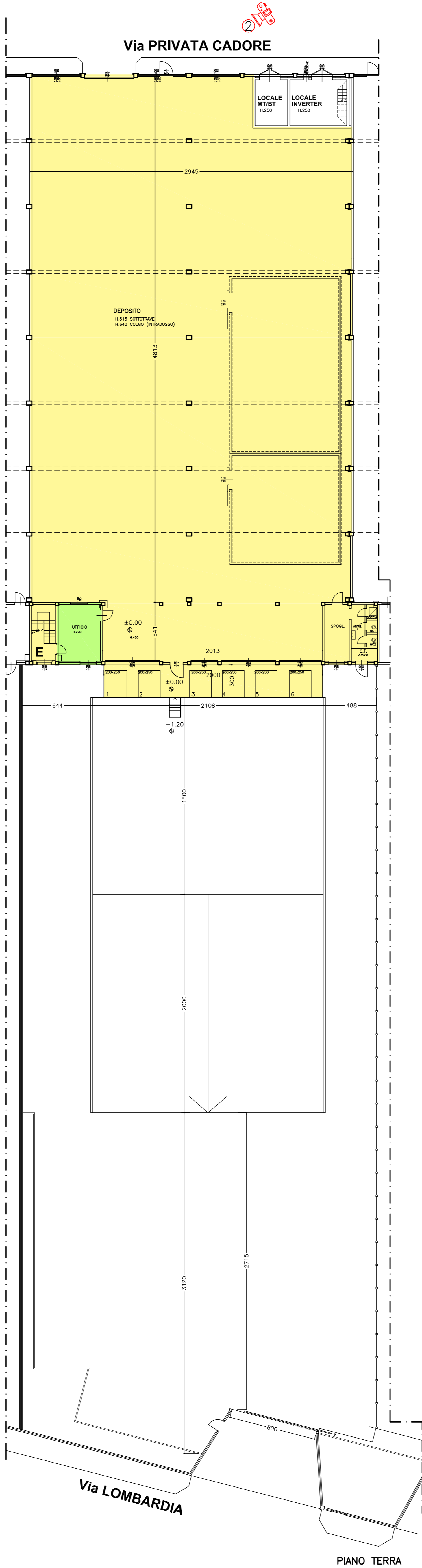

PIANO TERRA

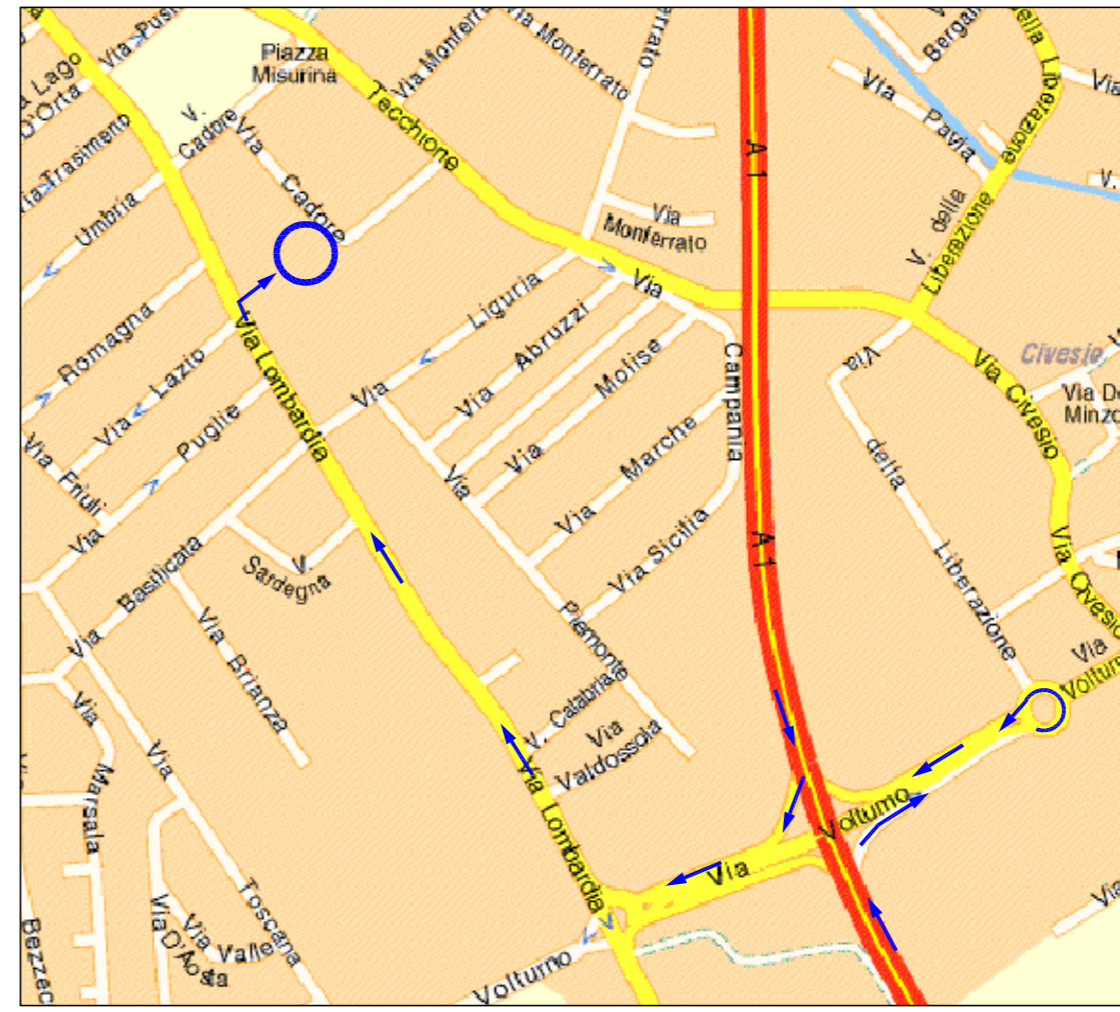

VISTA 1





VISTA 2

LEGENDA

 VISTA FOTOGRAFICA

LEGENDA

	S.L.P. UFFICI PIANO 1':	mq. 176,00
	S.L.P. UFFICI PIANO TERRA:	mq. 23,00
	S.L.P. MAGAZZINO E SERVIZI:	mq. 1627,00
	S.L.P. TOTALE:	mq. 1826,00
	S.L.P. PIAZZALE:	mq. 2140,00 (circa)